

# Product Information

---

---

DT Accessories  
DT-GSM

---

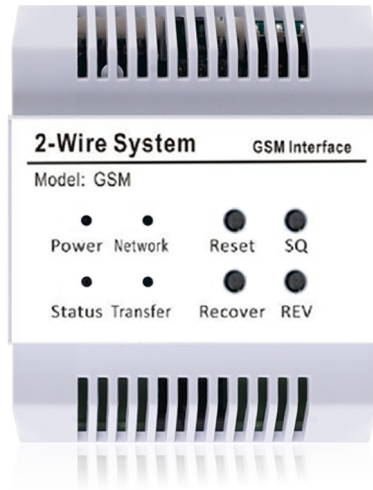

---

## DESCRIPTION

The GSM unit is a telephone converter designed for DT 2-wire system to divert calls from outdoor station to mobile phone.

## DIMENSION

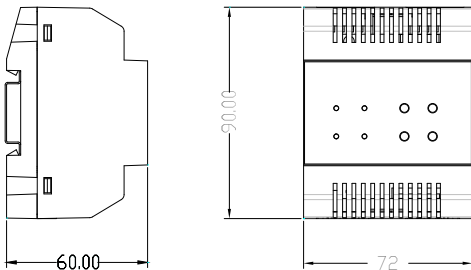

## FEATURES

- ☑ Call converter modular;
  - ☑ 4 band universal technology;
  - ☑ Remotely talk & unlock via phone;
  - ☑ Call converting to max.3 phone No. in turn;
  - ☑ SMS sending to registered mobile phone number;
  - ☑ Signal strength display for installation.
-

## 1.Parts and Functions

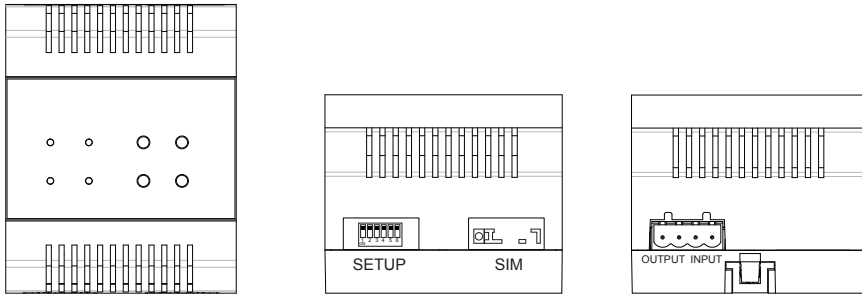

SETUP:

SIM:

Output:

Input:

DIP switches.

SIM card slot.

Output port,connect to Monitor.

Input port,connect to power supply.

## 2. Unit Mounting

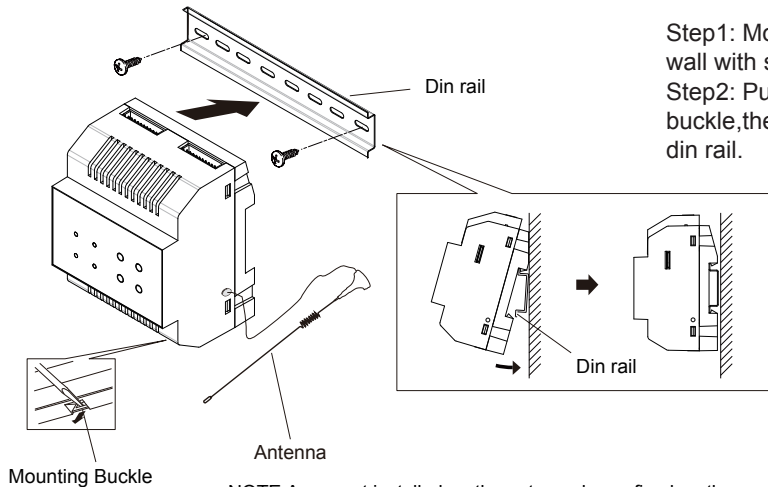

Step1: Mount the din rail to the wall with screws ;

Step2: Pull down the mounting buckle,then hang the unit on din rail.

NOTE:A magnet installed on the antenna base, fixed on the wall directly adsorbed iron (iron Fortunately, pre-installed on the wall) place. In addition, the antenna should be installed in the open place, there should be no obstructions around.

### 3. Specification

- Power Supply : DC 20~28V (supplied by PC6);
- Power Consumption: Standby 60mA; Working status 500mA;
- Working temperature: -15°C ~ +55°C;
- Wiring: 2 wire,non-polarity
- Dimension: 90(H)X72(W)X60(D)mm.

### 4. Packing Information



Dimensions: 153(H)×148(W)×68(D)mm  
Gross Weight: 0.3Kg

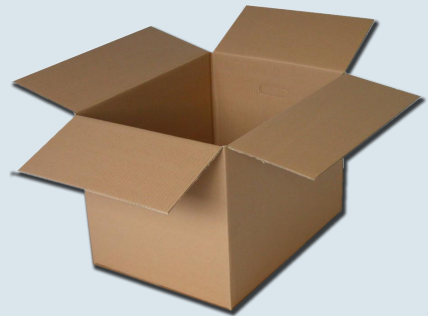

Carton: 495 (H)×403 (W)×310 (D)mm  
Quantity: 30PCS