

# Product Information

---

## DT16 Series 2-Wire Indoor Monitor

---



---

### DESCRIPTION

2-wire system 3.5 inch color TFT Monitor

### DIMENSION

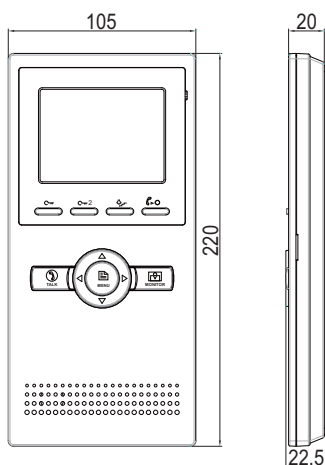

### FEATURES

- \*1 Plastic housing or Plastic housing with aluminum front panel;
  - ▶ Streamlined & thin design with 20mm thickness only;
  - ▶ Text menu;
  - ▶ 12pcs 8-chord Melodies for choose freely;
  - ▶ Compatible with all DT outdoor & Indoor stations ;
  - \*1 Multi languages and remote controller operation(customized);
  - \*1 Depends on models
-

## 1. Parts and Functions

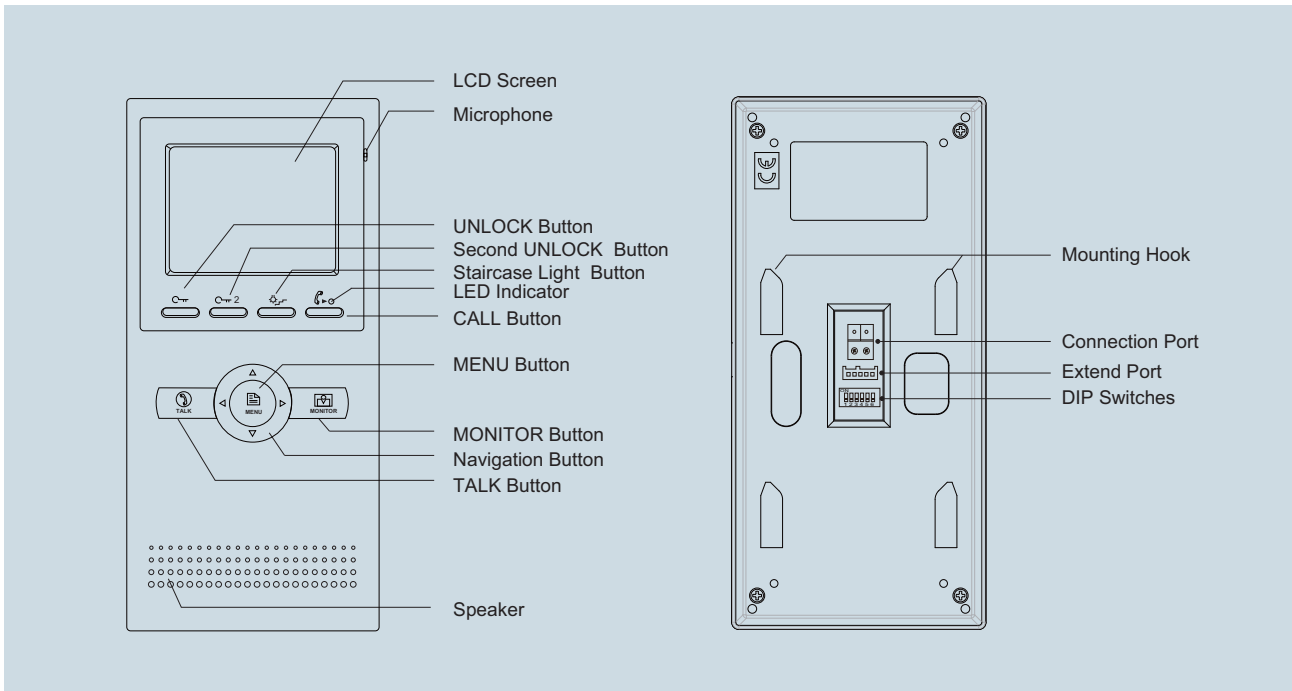

## 2. Monitor Mounting

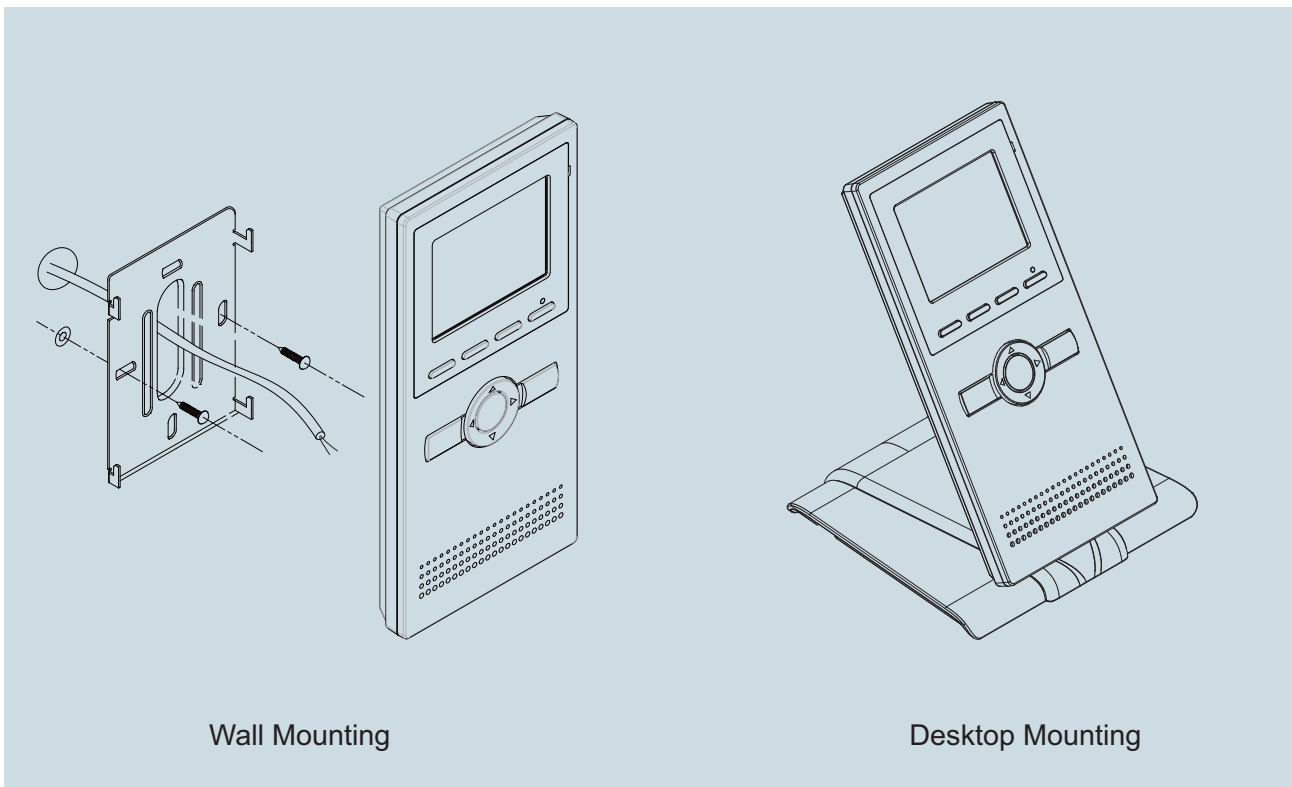

### 3. Specification

- \* Power Supply : DC 24V (supplied by PS4-24V or PS5-24V);
- \* Power Consumption: Standby 15mA; Working status 200mA;
- \* Display Device: 3.5 inch Digital TFT screen;
- \* Resolution: 320 x 240 pixels;
- \* Wiring: 2 wires (non-polarity);
- \* Monitor Dimension: 220(H)×105(W)×20(D)mm

### 4. Ordering Information for Monitor

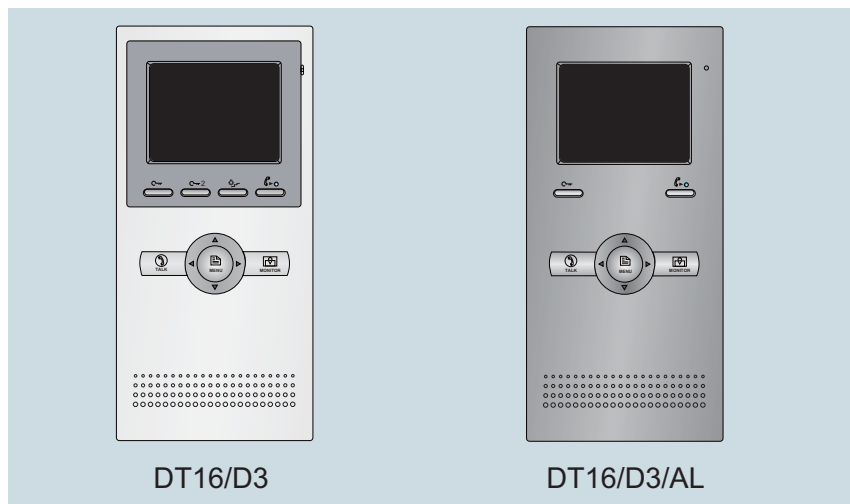



| Model No.  | Brief Description   | Menu Style |
|------------|---|------------|
| DT16/D3    | 3.5 inch digital color TFT screen monitor with white housing        | Text menu  |
| DT16/D3/AL | 3.5 inch digital color TFT Screen monitor with aluminum front panel |            |

### 5. Optional Accessories (Not included)

| Item  | Brief Description               | Remark               |
|-------|---------------------------------|----------------------|
| DB1-W | Desk top bracket in white color | For desktop mounting |
| DB1-B | Desk top bracket in black color | For desktop mounting |

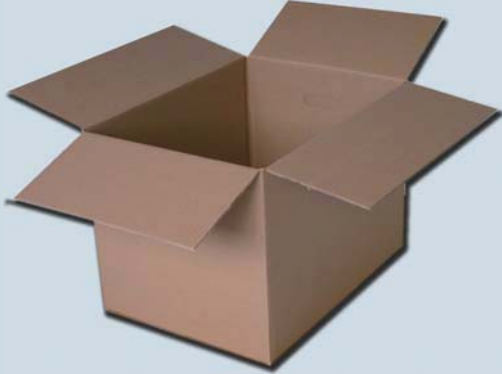
## 6. Packing Information



Dimensions: 249(H)×113(W)×37(D)mm  
Gross Weight: 0.39Kg(0.49KG for DT16/D3/AL)

Carton: 530 (H)×340 (W)×258 (D)mm  
Quantity: 36PCS

## 7. App: Menu style

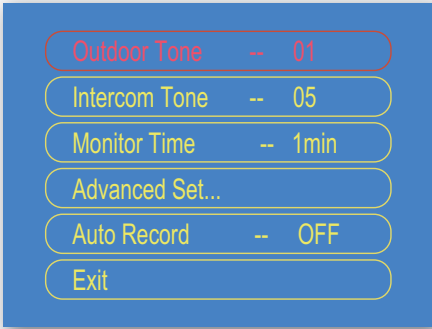

Text Menu Style